

MISCELLANEOUS INFORMATION

PERIMETER:-	75'-9"
SURFACE AREA:	457 SQ FT
VOLUME:	9949 IMP GALS 45267 L

PARTS LIST

CODE	QTY	DESCRIPTION
8R12-s	1	8'-0" Skimmer x 12'-0" Rad
8R12-i	1	8'-0" Return x 12'-0" Rad
8R12	7	8'-0" Plain x 12'-0" Rad
39R12	1	3'-9" Plain x 12'-0" Rad
NB	100	Nuts & Bolts

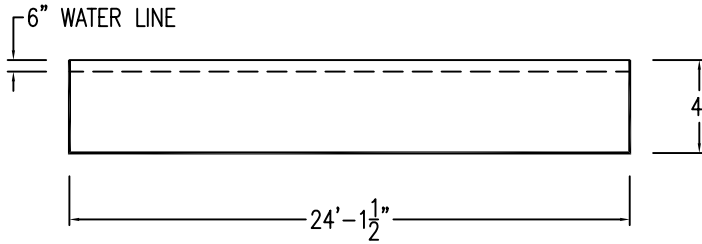

INSTALLATION DATA

From Point "A" to:-		From Point "B" to:-	
B	12'-0 5/8"	B	3'-8 7/8"
C	12'-0 5/8"	C	11'-3 1/2"
D	12'-0 5/8"	D	17'-7 3/8"
E	12'-0 5/8"	E	22'-0 1/4"
F	12'-0 5/8"	F	24'-0 1/4"
G	12'-0 5/8"	G	23'-4 3/4"
H	12'-0 5/8"	H	20'-2 3/4"
J	12'-0 5/8"	J	14'-10 1/4"
K	12'-0 5/8"	K	7'-10 1/4"
L	12'-0 5/8"	L	7'-10 1/4"

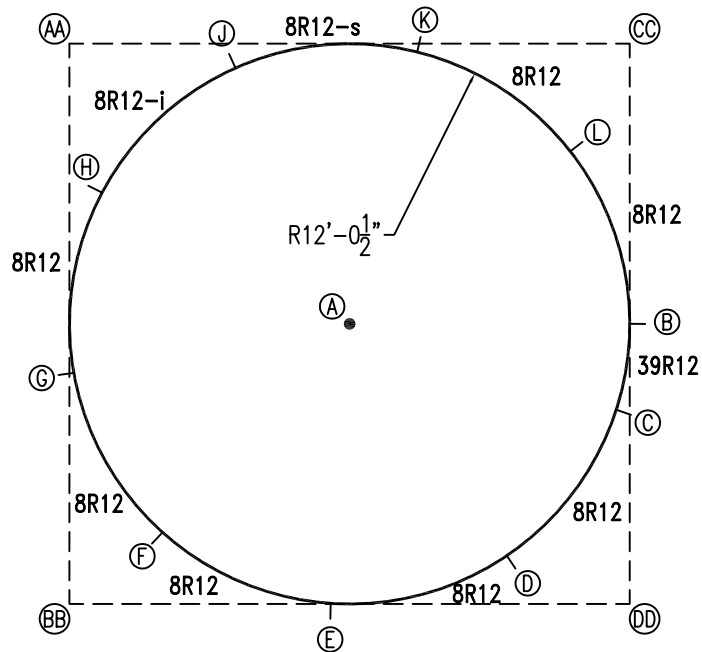

EXTERNAL INSTALLATION DATA

AA TO:	BB TO:	CC TO:	DD TO:
AA ---	AA 24'-1 3/8"	AA 24'-1 3/8"	AA 34'-1 1/4"
BB ---	BB ---	BB 34'-1 1/4"	BB 24'-1 3/8"
CC ---	CC ---	CC ---	CC 24'-1 3/8"
A 17'-0 5/8"	A 17'-0 5/8"	A 17'-0 5/8"	A 17'-0 5/8"
B 26'-11 1/2"	B 26'-11 1/2"	B 12'-0 5/8"	B 12'-0 5/8"
C 28'-3 3/4"	C 24'-11 3/4"	C 15'-9 1/8"	C 8'-4 5/8"
D 28'-11 3/4"	D 18'-11 1/4"	D 22'-7 7/8"	D 5'-8 1/4"
E 26'-6 7/8"	E 11'-2 7/8"	E 27'-3 3/4"	E 12'-10 1/2"
F 21'-4 7/8"	F 5'-0 5/8"	F 29'-1 1/8"	F 20'-4 1/8"
G 14'-2"	G 9'-11 3/8"	G 27'-9 5/8"	G 25'-10 7/8"
H 6'-6 3/4"	H 17'-9 1/8"	H 23'-7 1/8"	H 28'-9 1/2"
J 7'-2 5/8"	J 24'-1 3/4"	J 17'-0"	J 28'-7 5/8"
K 14'-11 5/8"	K 28'-0 7/8"	K 9'-1 7/8"	K 25'-5 1/2"
L 22'-0 1/2"	L 29'-0 5/8"	L 5'-3 1/2"	L 19'-7 3/4"

*ALL DIMENSIONS ARE FINISHED

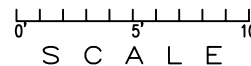

NOTICE

SWIMMING POOLS AND ACCESSORIES (INCLUDING DIVING BOARDS) ARE DANGEROUS WHEN IMPROPERLY USED OR INSTALLED. IT IS THE RESPONSIBILITY OF MUNICIPAL OFFICIALS, BUILDERS AND POOL OWNERS TO ADHERE TO ALL SAFETY RECOMMENDATIONS AND STANDARDS ISSUED BY THE POOL & HOT TUB COUNCIL, LOCAL AUTHORITIES AND EQUIPMENT MANUFACTURERS. PLEASE REFER TO DIVING BOARD MANUFACTURERS FOR CORRECT POSITIONING AND INSTALLATION OF DIVING EQUIPMENT.