

**MISCELLANEOUS INFORMATION**

|               |                           |
|---------------|---------------------------|
| PERIMETER:    | 90'10"                    |
| SURFACE AREA: | 429 SQ FT                 |
| VOLUME:       | 9490 IMP GALS 43180 LITER |

**PARTS LIST**

| CODE | QTY | DESCRIPTION                 |
|------|-----|-----------------------------|
| 2RC  | 5   | 3'2" Plain x 2' Rad Cnr     |
| 8    | 5   | 8' Plain                    |
| 8-s  | 1   | 8' Skimmer                  |
| 4    | 2   | 4' Plain                    |
| 8-i  | 2   | 8' Return                   |
| 2RCR | 1   | 3'2" Plain x 2' Rev Rad Cnr |
| AF   | 16  | A-Frame                     |
| S    | 32  | Stakes                      |
| NB   | 96  | Nuts & Bolts                |

**CONCRETE DECK INFO**

| WIDTH | AREA | NET INCREASES FOR: |        |       |        |
|-------|------|--------------------|--------|-------|--------|
|       |      | STEPS              | DIVING | SLIDE | ROLLER |
| 2'    | 194  | 13                 | 27     | 24    | 10     |
| 2'6"  | 246  | 17                 | 31     | 20    | 10     |
| 3'    | 300  | 20                 | 36     | 16    | 10     |

All Figures Represent "Sq Ft"

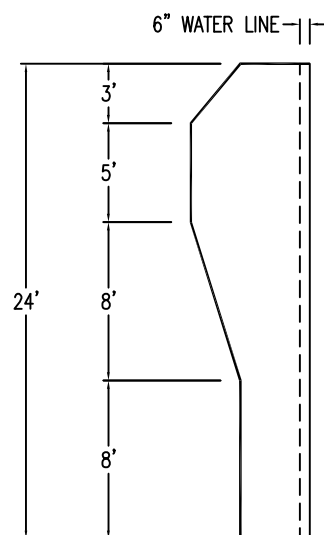
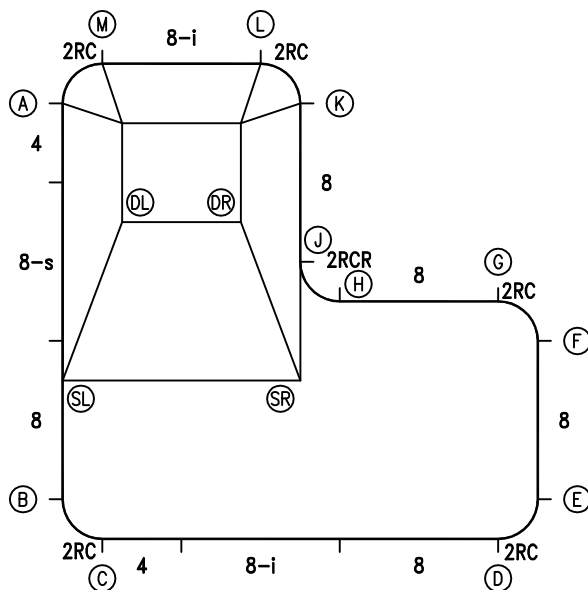

**INSTALLATION DATA**

| From Point "A" to:- |            | From Point "B" to:- |             |
|---------------------|------------|---------------------|-------------|
| B                   | 20'-0"     | B                   | 2'-9 3/4"   |
| C                   | 22'-1"     | C                   | 22'-1"      |
| D                   | 31'-1 1/4" | D                   | 24'-0"      |
| E                   | 31'-2 3/4" | E                   | 25'-3 1/2"  |
| F                   | 26'-9 3/4" | F                   | 24'-1 3/4"  |
| G                   | 24'-1 3/4" | G                   | 17'-2 1/2"  |
| H                   | 17'-2 1/2" | H                   | 16'-11 1/2" |
| J                   | 14'-5"     | J                   | 23'-3 3/4"  |
| K                   | 12'-0"     | K                   | 24'-1 3/4"  |
| L                   | 10'-2 1/4" | L                   | 22'-1"      |
| M                   | 2'-9 3/4"  | M                   | 6'-0"       |
| SL                  | 14'-0"     | SL                  | 13'-4 3/4"  |
| SR                  | 18'-5 1/4" | SR                  | 14'-3 3/4"  |
| DL                  | 6'-8 1/2"  | DL                  | 16'-7 3/4"  |
| DR                  | 10'-9 3/4" | DR                  |             |

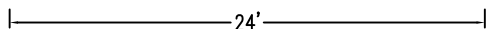

\*ALL DIMENSIONS ARE FINISHED

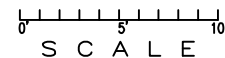

**NOTICE**

SWIMMING POOLS AND ACCESSORIES (INCLUDING DIVING BOARDS) ARE DANGEROUS WHEN IMPROPERLY USED OR INSTALLED. IT IS THE RESPONSIBILITY OF MUNICIPAL OFFICIALS, BUILDERS AND POOL OWNERS TO ADHERE TO ALL SAFETY RECOMMENDATIONS AND STANDARDS ISSUED BY THE POOL & HOT TUB COUNCIL, LOCAL AUTHORITIES AND EQUIPMENT MANUFACTURERS. PLEASE REFER TO DIVING BOARD MANUFACTURERS FOR CORRECT POSITIONING AND INSTALLATION OF DIVING EQUIPMENT.

PERIMETER: 90'10"

EXTERNAL INSTALLATION DATA

| AA TO:        | BB TO:        | CC TO:         | DD TO:         |
|---------------|---------------|----------------|----------------|
| AA --         | AA 24'-0"     | AA 24'-0"      | AA 33'-11 1/4" |
| BB --         | BB --         | BB 33'-11 1/4" | BB 24'-0"      |
| CC --         | CC --         | CC --          | CC 24'-0"      |
| A 2'-0"       | A 22'-0"      | A 24'-0 3/4"   | A 32'-6 3/4"   |
| B 22'-0"      | B 2'-0"       | B 32'-6 3/4"   | B 24'-0 3/4"   |
| C 24'-0 3/4"  | C 2'-0"       | C 32'-6 3/4"   | C 22'-0"       |
| D 32'-6 3/4"  | D 22'-0"      | D 24'-0 3/4"   | D 2'-0"        |
| E 32'-6 3/4"  | E 24'-0 3/4"  | E 22'-0"       | E 2'-0"        |
| F 27'-9 1/4"  | F 26'-0"      | F 14'-0"       | F 10'-0"       |
| G 25'-0 3/4"  | G 25'-0 3/4"  | G 12'-1 3/4"   | G 12'-1 3/4"   |
| H 18'-5 1/4"  | H 18'-5 1/4"  | H 15'-7 1/2"   | H 15'-7 1/2"   |
| J 15'-7 1/2"  | J 18'-5 1/4"  | J 15'-7 1/2"   | J 18'-5 1/4"   |
| K 12'-1 3/4"  | K 25'-0 3/4"  | K 12'-1 3/4"   | K 25'-0 3/4"   |
| L 10'-0"      | L 26'-0"      | L 14'-0"       | L 27'-9 1/4"   |
| M 2'-0"       | M 24'-0 3/4"  | M 22'-0"       | M 32'-6 3/4"   |
| SL 16'-0"     | SL 8'-0"      | SL 28'-10"     | SL 25'-3 1/2"  |
| SR 20'-0"     | SR 14'-5"     | SR 20'-0"      | SR 14'-5"      |
| DL 8'-6 1/2"  | DL 16'-3 1/4" | DL 22'-5 1/2"  | DL 26'-4 3/4"  |
| DR 12'-0 1/2" | DR 18'-4 1/4" | DR 17'-0"      | DR 21'-11"     |

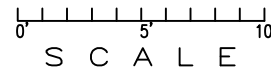
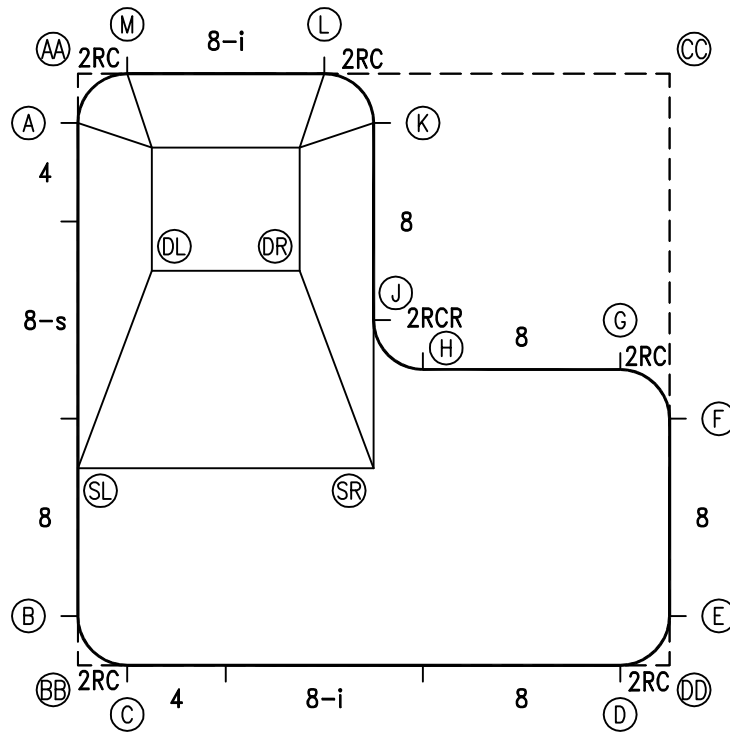

NOTICE

SWIMMING POOLS AND ACCESSORIES (INCLUDING DIVING BOARDS) ARE DANGEROUS WHEN IMPROPERLY USED OR INSTALLED. IT IS THE RESPONSIBILITY OF MUNICIPAL OFFICIALS, BUILDERS AND POOL OWNERS TO ADHERE TO ALL SAFETY RECOMMENDATIONS AND STANDARDS ISSUED BY THE POOL & HOT TUB COUNCIL, LOCAL AUTHORITIES AND EQUIPMENT MANUFACTURERS. PLEASE REFER TO DIVING BOARD MANUFACTURERS FOR CORRECT POSITIONING AND INSTALLATION OF DIVING EQUIPMENT.

HIGHBURY POOLS LTD

FULL L - RIGHT 12 x 24 x 24

DRAWING REFERENCE #  
10-12-24-2

DRAWN BY: JK  
REV. 4 JUL 13  
SHEET 2 OF 2