

MISCELLANEOUS INFORMATION

PERIMETER:	64'
SURFACE AREA:	275 SQ FT
VOLUME:	6538 IMP GALS 29748 LITER

CONCRETE DECK INFO

WIDTH	AREA	NET INCREASES FOR:			
		STEPS	DIVING	SLIDE	ROLLER
2'	141	13	27	24	10
2'6"	180	17	31	20	10
3'	221	20	36	16	10

All Figures Represent "Sq Ft"

PARTS LIST

CODE	QTY	DESCRIPTION
3R6	2	3' Plain x 6' Radius
8R6-i	2	8' Return x 6' Radius
76R6	2	7'6" Plain x 6' Radius
56R6R	2	5'6" Plain x 6' Reverse Radius
6R4-s	1	6' Skimmer x 4' Radius
2R4R	2	2' Plain x 4' Reverse Radius
6R4	1	6' Plain x 4' Radius
AF	12	A-Frame
S	24	Stakes
NB	72	Nuts & Bolts

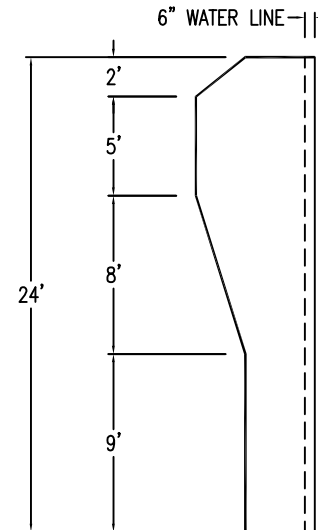
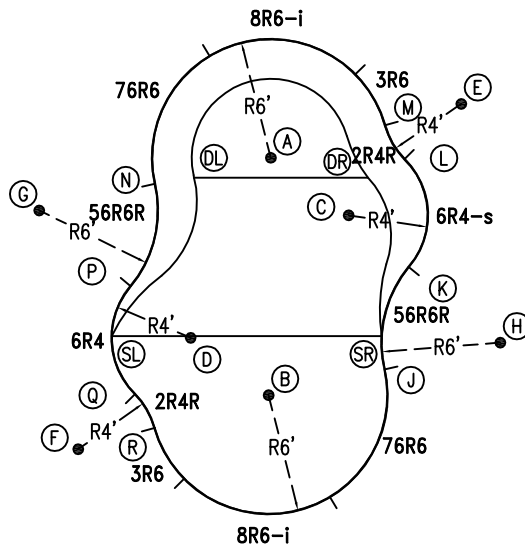

INSTALLATION DATA

From Point "A" to:-		From Point "B" to:-	
B	11'-11 3/4"	B	9'-11 1/4"
C	4'-10 1/2"	C	4'-10 1/2"
D	9'-11 1/4"	D	4'-10 1/2"
E	10'-0"	E	17'-7 3/4"
F	17'-7 3/4"	F	10'-0"
G	12'-0"	G	14'-10 1/2"
H	14'-10 1/2"	H	12'-0"
J	12'-1 1/2"	J	6'-0"
K	8'-10 1/2"	K	9'-7"
L	6'-9"	L	13'-9"
M	6'-0"	M	14'-10 1/4"
N	6'-0"	N	12'-1 1/2"
P	9'-7"	P	8'-10 1/2"
Q	13'-9"	Q	6'-9"
R	14'-10 1/4"	R	6'-0"
SL	12'-0 3/4"	SL	8'-5 3/4"
SR	10'-7 1/4"	SR	6'-5 1/4"
DL	4'-0"	DL	11'-7 1/2"
DR	5'-0 1/4"	DR	12'-1"

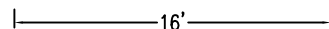

*ALL DIMENSIONS ARE FINISHED

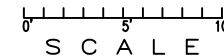

NOTICE

SWIMMING POOLS AND ACCESSORIES (INCLUDING DIVING BOARDS) ARE DANGEROUS WHEN IMPROPERLY USED OR INSTALLED. IT IS THE RESPONSIBILITY OF MUNICIPAL OFFICIALS, BUILDERS AND POOL OWNERS TO ADHERE TO ALL SAFETY RECOMMENDATIONS AND STANDARDS ISSUED BY THE POOL & HOT TUB COUNCIL, LOCAL AUTHORITIES AND EQUIPMENT MANUFACTURERS. PLEASE REFER TO DIVING BOARD MANUFACTURERS FOR CORRECT POSITIONING AND INSTALLATION OF DIVING EQUIPMENT.

HIGHBURY POOLS LTD

LIBERTY - LEFT 12 x 16 x 24

DRAWING REFERENCE #
96-12-24-1

DRAWN BY: JK
REV. 29 AUG 13
SHEET 1 OF 2

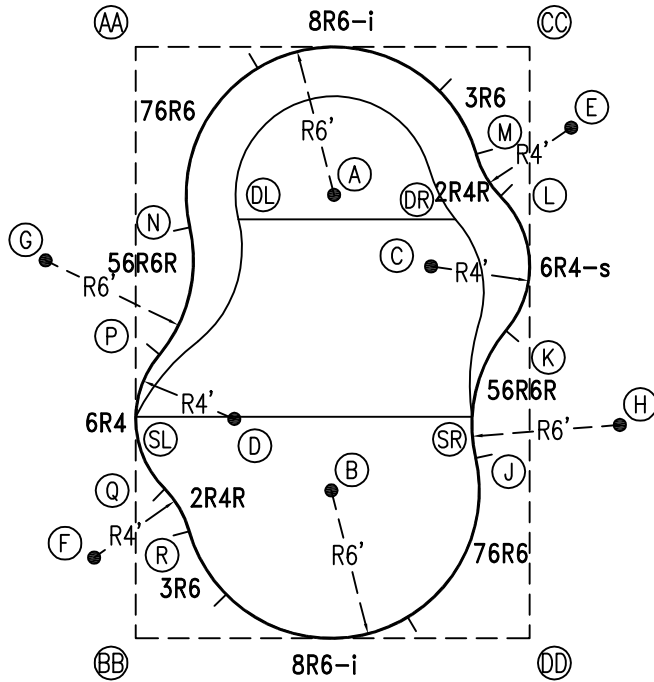

EXTERNAL INSTALLATION DATA

AA TO:	BB TO:	CC TO:	DD TO:
AA ---	AA 23'-11 3/4"	AA 15'-11 3/4"	AA 28'-9 3/4"
BB ---	BB ---	BB 28'-9 3/4"	BB 15'-11 3/4"
CC ---	CC ---	CC ---	CC 23'-11 3/4"
A 10'-0 1/4"	A 19'-8 1/2"	A 9'-11 1/4"	A 19'-7 3/4"
B 19'-7 3/4"	B 9'-11 1/4"	B 19'-8 1/2"	B 10'-0 1/4"
C 14'-11"	C 19'-3 1/4"	C 9'-9"	C 15'-7 1/4"
D 15'-7 1/4"	D 9'-9"	D 19'-3 1/4"	D 14'-11"
E 17'-11 1/2"	E 27'-2 3/4"	E 3'-8 1/4"	E 20'-9 1/2"
F 20'-9 1/2"	F 3'-8 1/4"	F 27'-2 3/4"	F 17'-11 1/2"
G 9'-4 3/4"	G 15'-9"	G 21'-5 1/2"	G 24'-10 3/4"
H 24'-10 3/4"	H 21'-5 1/2"	H 15'-9"	H 9'-4 3/4"
J 21'-7 3/4"	J 15'-7 1/4"	J 16'-9 3/4"	J 7'-7 1/2"
K 18'-11"	K 19'-6 1/4"	K 11'-6 1/2"	K 12'-6 1/4"
L 15'-11 3/4"	L 23'-2 3/4"	L 6'-2"	L 17'-11 1/2"
M 14'-5 3/4"	M 24'-0 1/4"	M 4'-10 1/4"	M 19'-9 1/4"
N 7'-7 1/2"	N 16'-9 3/4"	N 15'-7 1/4"	N 21'-7 3/4"
P 12'-6 1/4"	P 11'-6 1/2"	P 19'-6 1/4"	P 18'-11"
Q 17'-11 1/2"	Q 6'-2"	Q 23'-2 3/4"	Q 15'-11 3/4"
R 19'-9 1/4"	R 4'-10 1/4"	R 24'-0 1/4"	R 14'-5 3/4"
SL 15'-0"	SL 8'-11 3/4"	SL 21'-11"	SL 18'-4"
SR 20'-3 1/4"	SR 16'-4"	SR 15'-2"	SR 9'-3 1/2"
DL 8'-1 3/4"	DL 17'-5 3/4"	DL 13'-8 3/4"	DL 20'-8 1/4"
DR 14'-8 3/4"	DR 21'-4 1/2"	DR 7'-7 1/2"	DR 17'-3"

DIAGONALS

From Point "J" to:-	From Point "K" to:-
K 5'-3 3/4"	K
L 10'-7 7/8"	L 5'-5 3/8"
M 12'-3 7/8"	M 7'-3 1/8"
N 14'-10 7/8"	N 13'-5 7/8"
P 13'-5 7/8"	P 14'-0 7/8"
Q 12'-8"	Q 15'-2 7/8"
R 12'-0"	R 15'-2 1/2"

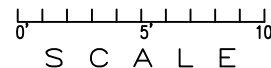

NOTICE

SWIMMING POOLS AND ACCESSORIES (INCLUDING DIVING BOARDS) ARE DANGEROUS WHEN IMPROPERLY USED OR INSTALLED. IT IS THE RESPONSIBILITY OF MUNICIPAL OFFICIALS, BUILDERS AND POOL OWNERS TO ADHERE TO ALL SAFETY RECOMMENDATIONS AND STANDARDS ISSUED BY THE POOL & HOT TUB COUNCIL, LOCAL AUTHORITIES AND EQUIPMENT MANUFACTURERS. PLEASE REFER TO DIVING BOARD MANUFACTURERS FOR CORRECT POSITIONING AND INSTALLATION OF DIVING EQUIPMENT.