

MISCELLANEOUS INFORMATION

PERIMETER:-	89'6
SURFACE AREA:	524.7 SQ FT
VOLUME:	5836 IMP GALS 26553 L

CONCRETE DECK INFO

WIDTH	AREA	NET INCREASES FOR:			
		STEPS	DIVING	SLIDE	ROLLER
2'	192	13	27	24	10
2'6"	243	17	31	20	10
3'	297	20	36	16	10

All Figures Represent "Sq Ft"

PARTS LIST

CODE	QTY	DESCRIPTION
8R9-s	1	8' Skimmer x 9' Rad
8R9-i	1	8' Return x 9' Rad
8R9	1	8' Plain x 9' Rad
6R9	1	6' Plain x 9' Rad
5R9R	1	5' Plain x 9' Reverse Rad
8R7-i	1	8' Return x 7' Rad
8R7	3	8' Plain x 7' Rad
8R7R	1	8' Plain x 7' Reverse Rad
7R7R	1	7' Plain x 7' Reverse Rad
46R7	1	4'6" Plain x 7' Rad
3R7	1	3' Plain x 7' Rad
AF	13	A-Frame
S	26	Stake
NB	78	Nuts & Bolts

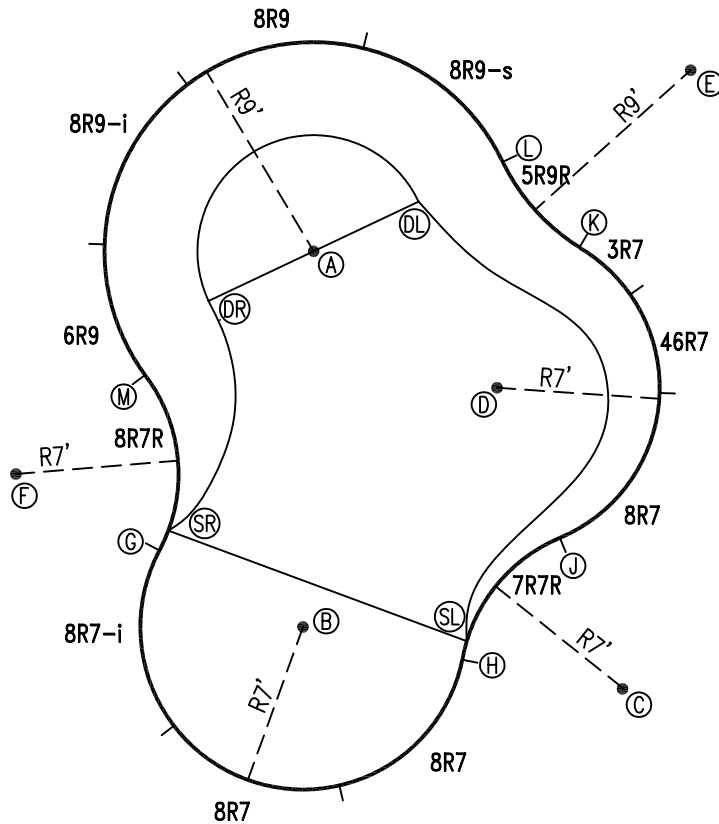

6" WATER LINE - I-I -

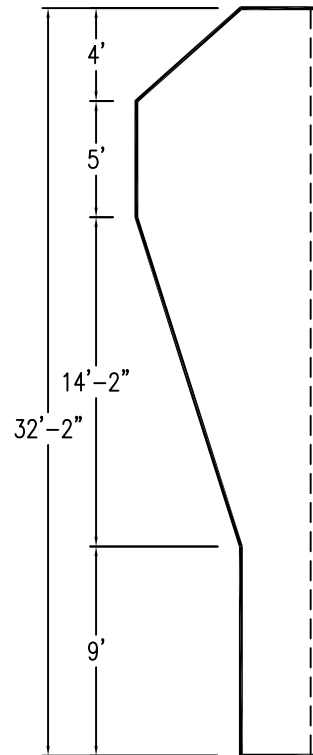

INSTALLATION DATA

From Point "A" to:-		From Point "B" to:-	
B	16'-2"	B	14'-0"
C	23'-0 1/4"	C	14'-0"
D	9'-10 1/8"	D	13'-3"
E	18'-0"	E	29'-2 3/8"
F	16'-0"	F	14'-0"
G	14'-5 3/4"	G	7'-0"
H	18'-8 3/8"	H	7'-0"
J	16'-3 1/8"	J	11'-8 3/8"
K	11'-5 1/4"	K	20'-2 3/8"
L	9'-0"	L	21'-9 3/8"
M	9'-0"	M	12'-9 1/2"
SL	18'-0 1/4"	SL	7'-0 7/8"
SR	13'-6 1/2"	SR	7'-1 1/2"
DL	5'-0"	DL	18'-11 5/8"
DR	5'-0"	DR	14'-7 1/4"

NOTICE

SWIMMING POOLS AND ACCESSORIES (INCLUDING DIVING BOARDS) ARE DANGEROUS WHEN IMPROPERLY USED OR INSTALLED. IT IS THE RESPONSIBILITY OF MUNICIPAL OFFICIALS, BUILDERS AND POOL OWNERS TO ADHERE TO ALL SAFETY RECOMMENDATIONS AND STANDARDS ISSUED BY THE POOL & HOT TUB COUNCIL, LOCAL AUTHORITIES AND EQUIPMENT MANUFACTURERS. PLEASE REFER TO DIVING BOARD MANUFACTURERS FOR CORRECT POSITIONING AND INSTALLATION OF DIVING EQUIPMENT.

*ALL DIMENSIONS ARE FINISHED

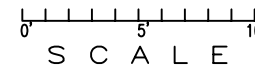

HIGHBURY POOLS LTD

MUSKOKA - LEFT 24 x 32

DRAWING REFERENCE #
26-24-32-1

DRAWN BY: BC
REV. 18 JAN 2007
SHEET 1 OF 2

EXTERNAL INSTALLATION DATA

AA TO:	BB TO:	CC TO:	DD TO:
AA ---	AA 32'-1 7/8"	AA 23'-10 3/4"	AA 40'-0 7/8"
BB ---	BB ---	BB 40'-0 7/8"	BB 23'-10 3/4"
CC ---	CC ---	CC ---	CC 32'-1 7/8"
A 12'-8 3/4"	A 24'-10 1/4"	A 17'-4 7/8"	A 27'-6 1/2"
B 26'-6 7/8"	B 11'-0 1/2"	B 29'-5 3/4"	B 16'-10 1/2"
C 35'-7 1/2"	C 22'-8 5/8"	C 27'-10"	C 4'-7 7/8"
D 22'-6 1/8"	D 24'-2 1/8"	D 16'-5 1/4"	D 18'-7 7/8"
E 25'-3"	E 39'-11 1/4"	E 1'-9 1/2"	E 30'-11 7/8"
F 18'-11 5/8"	F 14'-1 1/4"	F 33'-4 3/8"	F 30'-10 1/4"
G 22'-0"	G 10'-6 3/4"	G 30'-8 1/4"	G 23'-10 3/8"
H 30'-8 5/8"	H 16'-4 5/8"	H 27'-10 3/4"	H 10'-2"
J 28'-11 5/8"	J 22'-4 5/8"	J 21'-9 1/8"	J 11'-7 7/8"
K 22'-3 1/4"	K 31'-0 1/8"	K 9'-5 7/8"	K 23'-6 7/8"
L 17'-10 3/4"	L 31'-11 7/8"	L 8'-5 7/8"	L 27'-10 1/8"
M 14'-5 1/4"	M 17'-11 1/8"	M 26'-4 1/2"	M 28'-5 1/4"
SL 21'-2 3/8"	SL 11'-5 3/4"	SL 29'-9 3/4"	SL 23'-10 7/8"
SR 30'-1 1/2"	SR 16'-10 1/8"	SR 27'-0 7/8"	SR 10'-5 3/4"
DL 12'-0"	DL 21'-5 7/8"	DL 22'-4 5/8"	DL 28'-7 3/8"
DR 15'-1 7/8"	DR 28'-8 1/4"	DR 12'-5 1/4"	DR 27'-4 1/8"

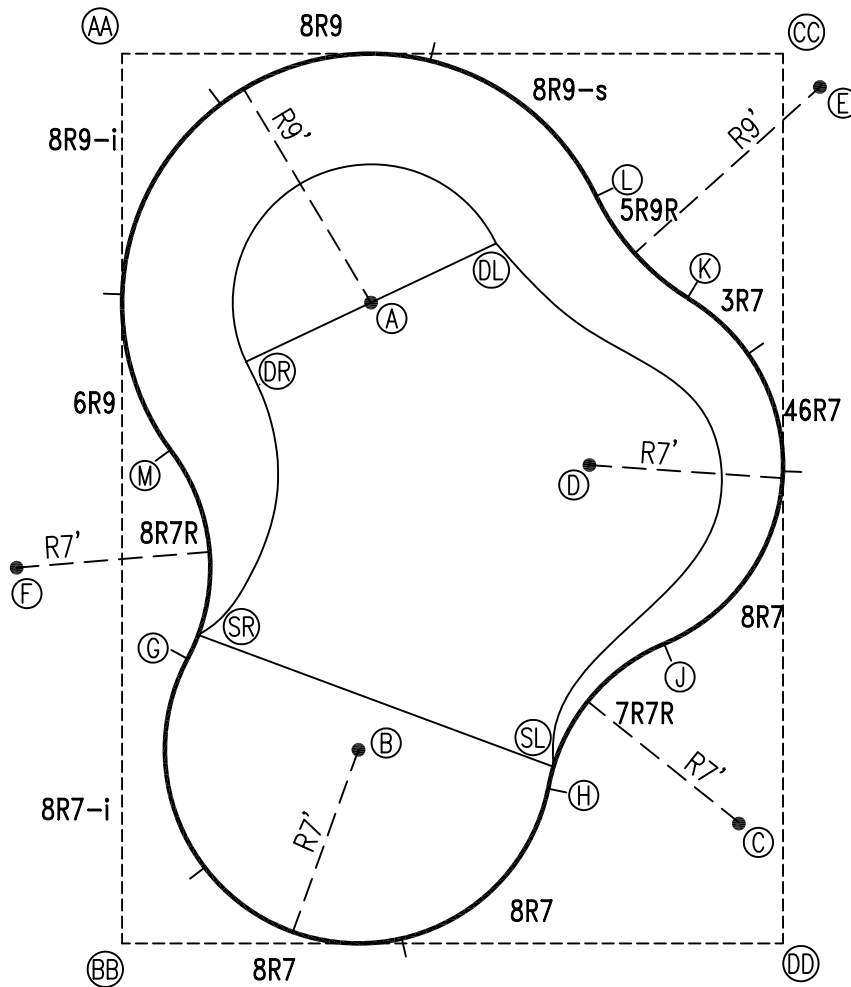

0' 5' 10'
SCALE

NOTICE

SWIMMING POOLS AND ACCESSORIES (INCLUDING DIVING BOARDS) ARE DANGEROUS WHEN IMPROPERLY USED OR INSTALLED. IT IS THE RESPONSIBILITY OF MUNICIPAL OFFICIALS, BUILDERS AND POOL OWNERS TO ADHERE TO ALL SAFETY RECOMMENDATIONS AND STANDARDS ISSUED BY THE POOL & HOT TUB COUNCIL, LOCAL AUTHORITIES AND EQUIPMENT MANUFACTURERS. PLEASE REFER TO DIVING BOARD MANUFACTURERS FOR CORRECT POSITIONING AND INSTALLATION OF DIVING EQUIPMENT.

HIGHBURY POOLS LTD

MUSKOKA - LEFT 24 x 32

DRAWING REFERENCE #
26-24-32-1

DRAWN BY: BC
REV. 18 JAN 2007
SHEET 2 OF 2