

MISCELLANEOUS INFORMATION

PERIMETER:	70'6"
SURFACE AREA:	320 SQ FT
VOLUME:	6960 IMP GALS 31668 LITER

PARTS LIST

CODE	QTY	DESCRIPTION
8R6	1	8' Plain x 6' Radius
3'9	3	3'9" Plain
3'9-s	1	3'9" Skimmer
39R76	1	3'9" Plain x 7'6 Radius
8R76	2	8' Plain x 7'6 Radius
8R76-i	1	8' Return x 7'6 Radius
8R9R	1	8' Plain x 9' Reverse Radius
39R6	1	3'9" Plain x 6' Radius
8R6-i	1	8' Return x 6' Radius
AF	12	A-Frame
S	24	Stakes
NB	72	Nuts & Bolts

CONCRETE DECK INFO

WIDTH	AREA	NET INCREASES FOR:			
		STEPS	DIVING	SLIDE	ROLLER
2'	153	13	27	24	10
2'6"	196	17	31	20	10
3'	239	20	36	16	10

All Figures Represent "Sq Ft"

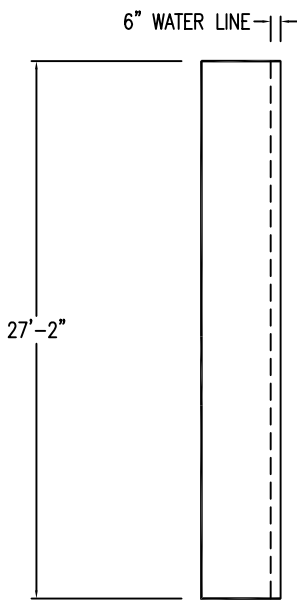
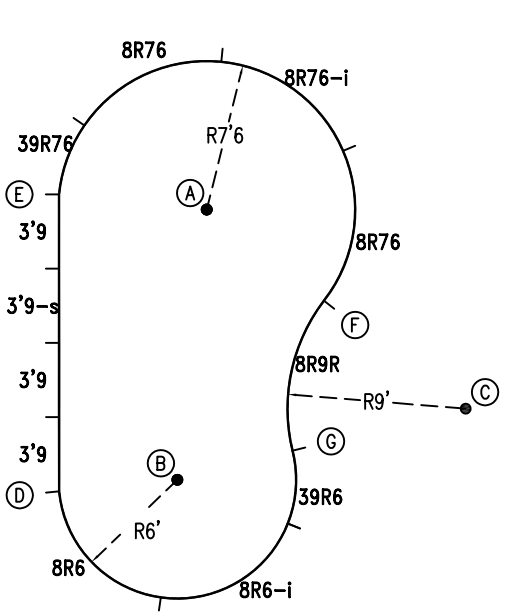

INSTALLATION DATA

From Point "A" to:-		From Point "B" to:-	
B	13'-8 3/4"	B	15'-0"
C	16'-5 3/4"	C	15'-0"
D	16'-0 3/4"	D	6'-0"
E	7'-5 3/4"	E	15'-7 1/4"
F	7'-5 3/4"	F	11'-8 1/4"
G	12'-11"	G	6'-0"

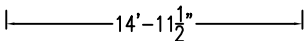

*ALL DIMENSIONS ARE FINISHED

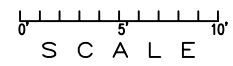

NOTICE

SWIMMING POOLS AND ACCESSORIES (INCLUDING DIVING BOARDS) ARE DANGEROUS WHEN IMPROPERLY USED OR INSTALLED. IT IS THE RESPONSIBILITY OF MUNICIPAL OFFICIALS, BUILDERS AND POOL OWNERS TO ADHERE TO ALL SAFETY RECOMMENDATIONS AND STANDARDS ISSUED BY THE POOL & HOT TUB COUNCIL, LOCAL AUTHORITIES AND EQUIPMENT MANUFACTURERS. PLEASE REFER TO DIVING BOARD MANUFACTURERS FOR CORRECT POSITIONING AND INSTALLATION OF DIVING EQUIPMENT.

EXTERNAL INSTALLATION DATA

AA TO:	BB TO:	CC TO:	DD TO:
AA --	AA 27'-1 3/4"	AA 14'-11 1/2"	AA 31'-0"
BB --	BB --	BB 31'-0"	BB 14'-11 1/2"
CC --	CC --	CC --	CC 27'-1 3/4"
A 10'-6 3/4"	A 21'-0 1/4"	A 10'-7 1/4"	A 21'-0 1/4"
B 21'-11 3/4"	B 8'-5 1/2"	B 22'-11 3/4"	B 10'-9 1/2"
C 27'-0 1/4"	C 22'-8"	C 18'-5"	C 11'-1"
D 21'-8 3/4"	D 5'-4 3/4"	D 26'-4 1/2"	D 15'-10 3/4"
E 6'-8 3/4"	E 20'-4 3/4"	E 16'-4 3/4"	E 25'-3 3/4"
F 18'-0 1/2"	F 20'-1 1/2"	F 12'-2 1/2"	F 15'-1 1/2"
G 22'-11 1/4"	G 13'-11 1/2"	G 19'-11"	G 8'-1 1/4"

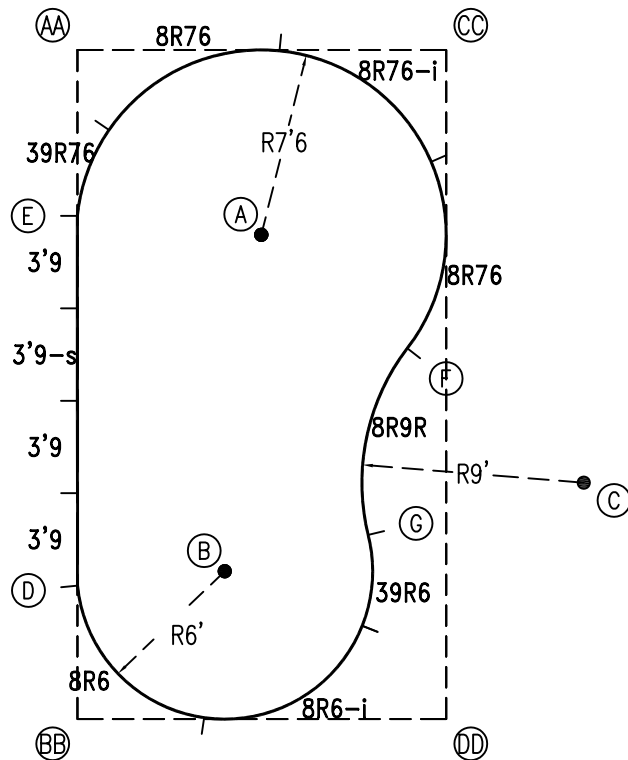

NOTICE

SWIMMING POOLS AND ACCESSORIES (INCLUDING DIVING BOARDS) ARE DANGEROUS WHEN IMPROPERLY USED OR INSTALLED. IT IS THE RESPONSIBILITY OF MUNICIPAL OFFICIALS, BUILDERS AND POOL OWNERS TO ADHERE TO ALL SAFETY RECOMMENDATIONS AND STANDARDS ISSUED BY THE POOL & HOT TUB COUNCIL, LOCAL AUTHORITIES AND EQUIPMENT MANUFACTURERS. PLEASE REFER TO DIVING BOARD MANUFACTURERS FOR CORRECT POSITIONING AND INSTALLATION OF DIVING EQUIPMENT.

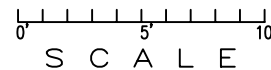

HIGHBURY POOLS LTD

KIDNEY-STRAIGHT BACK - RIGHT 15 x 15 x 27

DRAWING REFERENCE #
48 OG-16-15-27-2

DRAWN BY: JLG
REV. 6 JUL 12
SHEET 2 OF 2