

MISCELLANEOUS INFORMATION

PERIMETER:	103'
SURFACE AREA:	614 SQ FT
VOLUME:	15827 IMP GALS 72013 LITER

CONCRETE DECK INFO

WIDTH	AREA	NET INCREASES FOR:			
		STEPS	DIVING	SLIDE	ROLLER
2'	219	13	27	24	10
2'6"	277	17	31	20	10
3'	337	20	36	16	10

All Figures Represent "Sq Ft"

PARTS LIST

CODE	QTY	DESCRIPTION
8R12	3	8' Plain x 12' Radius
3R12	2	3' Plain x 12' Radius
3R10R	2	3' Plain x 10' Reverse Radius
76R10R	2	7'6" Plain x 10' Reverse Radius
3R6	2	3' Plain x 6' Radius
8R6-i	2	8' Return x 6' Radius
8R6	2	8' Plain x 6' Radius
3R5R	2	3' Plain x 5' Reverse Radius
8R12-s	1	8' Skimmer x 12' Radius
AF	18	A-Frame
S	36	Stakes
NB	108	Nuts & Bolts

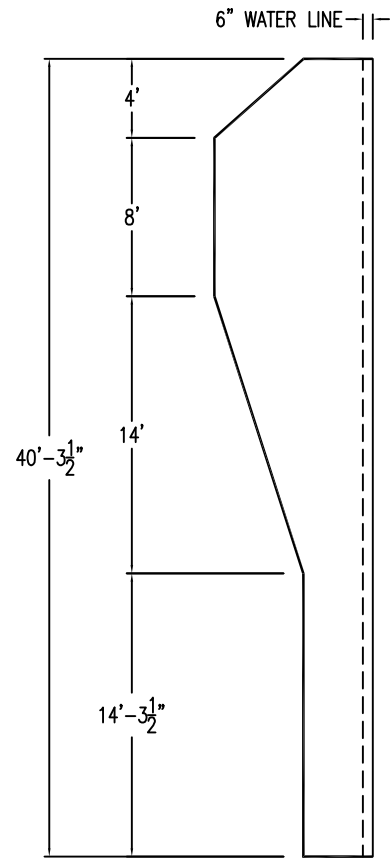
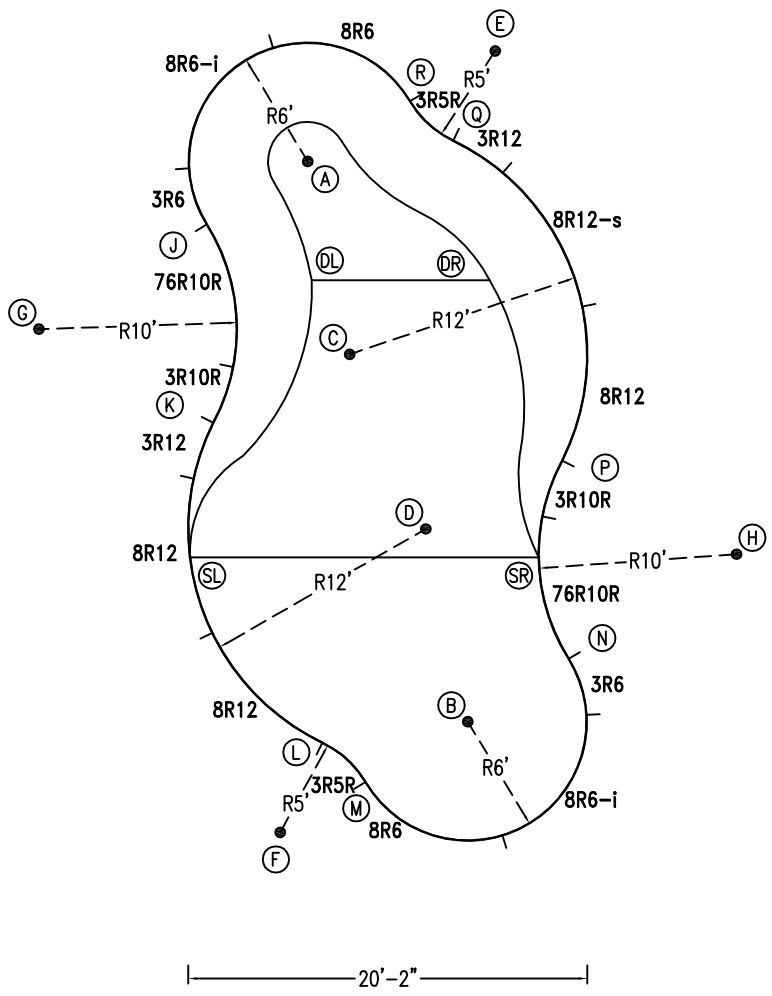

INSTALLATION DATA

From Point "A" to:-		From Point "B" to:-	
B	29'-5 1/4"	B	19'-5 3/4"
C	9'-11 1/2"	C	19'-11 1/2"
D	19'-5 3/4"	D	9'-11 1/2"
E	11'-0"	E	33'-10 3/4"
F	33'-10 3/4"	F	11'-0"
G	16'-0"	G	29'-4 1/2"
H	29'-4 1/2"	H	16'-0"
J	6'-0"	J	28'-4 1/2"
K	14'-0 1/4"	K	19'-10"
L	29'-4 1/4"	L	7'-5"
M	31'-5 3/4"	M	6'-0"
N	28'-4 1/2"	N	6'-0"
P	19'-10"	P	14'-0 1/4"
Q	7'-5"	Q	29'-4 1/4"
R	6'-0"	R	31'-5 3/4"
SL	20'-10 1/4"	SL	16'-3 3/4"
SR	23'-1 3/4"	SR	9'-0 1/2"
DL	6'-0"	DL	23'-7 3/4"
DR	10'-11 3/4"	DR	22'-3 3/4"

NOTICE

SWIMMING POOLS AND ACCESSORIES (INCLUDING DIVING BOARDS) ARE DANGEROUS WHEN IMPROPERLY USED OR INSTALLED. IT IS THE RESPONSIBILITY OF MUNICIPAL OFFICIALS, BUILDERS AND POOL OWNERS TO ADHERE TO ALL SAFETY RECOMMENDATIONS AND STANDARDS ISSUED BY THE POOL & HOT TUB COUNCIL, LOCAL AUTHORITIES AND EQUIPMENT MANUFACTURERS. PLEASE REFER TO DIVING BOARD MANUFACTURERS FOR CORRECT POSITIONING AND INSTALLATION OF DIVING EQUIPMENT.

*ALL DIMENSIONS ARE FINISHED

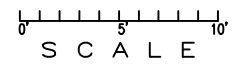

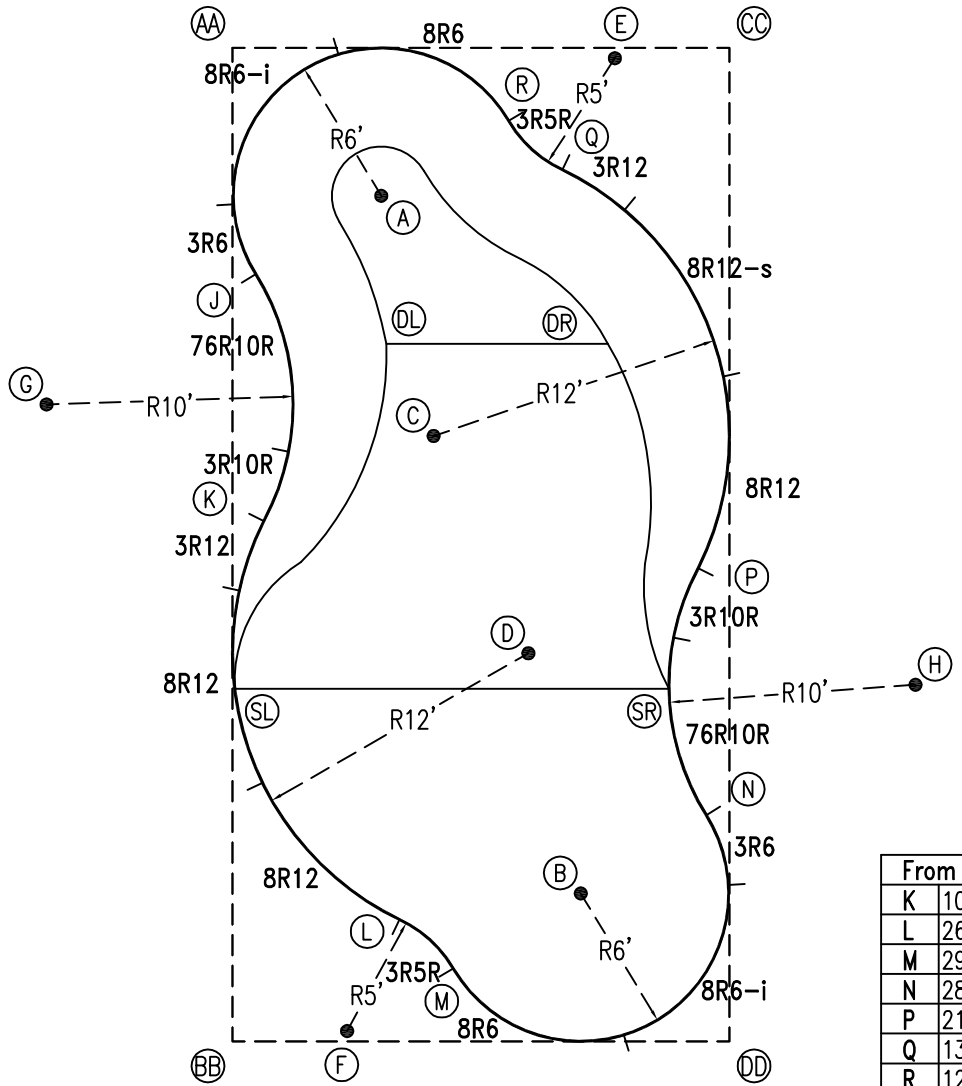

EXTERNAL INSTALLATION DATA

AA TO:	BB TO:	CC TO:	DD TO:
AA ---	AA 40'-3 1/2"	AA 20'-1 3/4"	AA 45'-0 3/4"
BB ---	BB ---	BB 45'-0 3/4"	BB 20'-1 3/4"
CC ---	CC ---	CC ---	CC 40'-3 1/2"
A 8'-6"	A 34'-9 3/4"	A 15'-4"	A 37'-1"
B 37'-1"	B 15'-4"	B 34'-9 3/4"	B 8'-6"
C 17'-8 3/4"	C 25'-10 1/2"	C 19'-9 1/2"	C 27'-4"
D 27'-4"	D 19'-9 1/2"	D 25'-10 1/2"	D 17'-8 3/4"
E 15'-6"	E 42'-9 1/2"	E 4'-7 3/4"	E 40'-1 3/4"
F 40'-1 3/4"	F 4'-7 3/4"	F 42'-9 1/2"	F 15'-6"
G 16'-3 3/4"	G 26'-10 3/4"	G 31'-3"	G 37'-10 1/2"
H 37'-10 1/2"	H 31'-3"	H 26'-10 3/4"	H 16'-3 3/4"
J 9'-2 1/2"	J 31'-1 3/4"	J 21'-3 1/2"	J 36'-6 3/4"
K 19'-2 3/4"	K 21'-1 3/4"	K 26'-11"	K 28'-3 3/4"
L 36'-0"	L 8'-4 1/2"	L 37'-9 3/4"	L 14'-3 1/4"
M 38'-4 3/4"	M 9'-5"	M 38'-11 3/4"	M 11'-6 3/4"
N 36'-6 3/4"	N 21'-3 1/2"	N 31'-1 3/4"	N 9'-2 1/2"
P 28'-3 3/4"	P 26'-11"	P 21'-1 3/4"	P 19'-2 3/4"
Q 14'-3 1/4"	Q 37'-9 3/4"	Q 8'-4 1/2"	Q 36'-0"
R 11'-6 3/4"	R 38'-11 3/4"	R 9'-5"	R 38'-4 3/4"
SL 26'-0"	SL 14'-3 1/2"	SL 32'-10"	SL 24'-7 3/4"
SR 31'-5 1/2"	SR 22'-9"	SR 26'-1 1/4"	SR 14'-6"
DL 13'-6 1/4"	DL 28'-11 3/4"	DL 18'-4 1/2"	DL 31'-6 1/2"
DR 19'-4 1/2"	DR 32'-1 1/2"	DR 12'-11 1/2"	DR 28'-8 3/4"

DIAGONALS

From Point "J" to:-	From Point "K" to:-
K 10'-0 1/4"	K
L 26'-9 7/8"	L 17'-0 7/8"
M 29'-3 1/2"	M 19'-8 5/8"
N 28'-6 3/4"	N 21'-6 5/8"
P 21'-6 5/8"	P 17'-8 3/4"
Q 13'-1 3/4"	Q 18'-8 1/2"
R 12'-0"	R 19'-0 3/8"

NOTICE

SWIMMING POOLS AND ACCESSORIES (INCLUDING DIVING BOARDS) ARE DANGEROUS WHEN IMPROPERLY USED OR INSTALLED. IT IS THE RESPONSIBILITY OF MUNICIPAL OFFICIALS, BUILDERS AND POOL OWNERS TO ADHERE TO ALL SAFETY RECOMMENDATIONS AND STANDARDS ISSUED BY THE POOL & HOT TUB COUNCIL, LOCAL AUTHORITIES AND EQUIPMENT MANUFACTURERS. PLEASE REFER TO DIVING BOARD MANUFACTURERS FOR CORRECT POSITIONING AND INSTALLATION OF DIVING EQUIPMENT.

