

MISCELLANEOUS INFORMATION

PERIMETER:	91'6"
SURFACE AREA:	505 SQ FT
VOLUME:	10990 IMP GALS 50004 LITER

PARTS LIST

CODE	QTY	DESCRIPTION
39R76	5	3'9" Plain x 7'6 Radius
3'g	4	3'9" Plain
3'g-s	1	3'9" Skimmer
39R9	5	3'9" Plain x 9' Radius
8R9	1	8' Plain x 9' Radius
8R9-i	1	8' Return x 9' Radius
39R9R	3	3'9" Plain x 9' Reverse Radius
8R76-i	1	8' Return x 7'6 Radius
AF	21	A-Frame
S	42	Stakes
NB	126	Nuts & Bolts

CONCRETE DECK INFO

WIDTH	AREA	NET INCREASES FOR:			
		STEPS	DIVING	SLIDE	ROLLER
2'	195	13	27	24	10
2'6"	248	17	31	20	10
3'	303	20	36	16	10

All Figures Represent "Sq Ft"

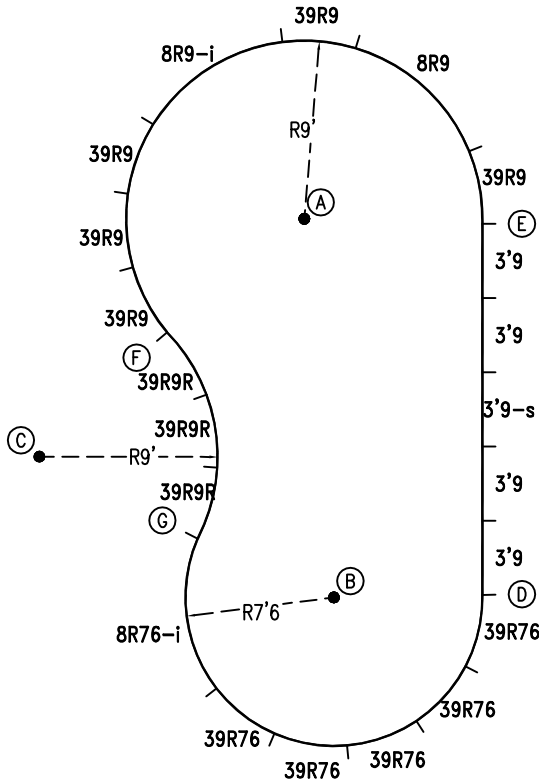

6" WATER LINE

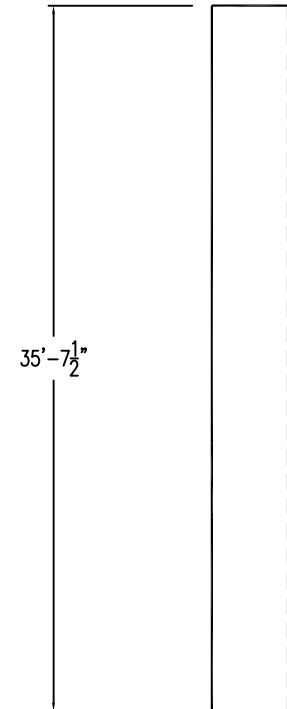

INSTALLATION DATA

From Point "A" to:-		From Point "B" to:-	
B	19'-2 1/4"	B	16'-5 3/4"
C	17'-11 3/4"	C	16'-5 3/4"
D	21'-0 1/4"	D	7'-6"
E	9'-0"	E	20'-3 3/4"
F	9'-0"	F	15'-9 3/4"
G	17'-0 1/4"	G	7'-5 3/4"

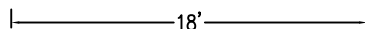

*ALL DIMENSIONS ARE FINISHED

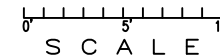

NOTICE

SWIMMING POOLS AND ACCESSORIES (INCLUDING DIVING BOARDS) ARE DANGEROUS WHEN IMPROPERLY USED OR INSTALLED. IT IS THE RESPONSIBILITY OF MUNICIPAL OFFICIALS, BUILDERS AND POOL OWNERS TO ADHERE TO ALL SAFETY RECOMMENDATIONS AND STANDARDS ISSUED BY THE POOL & HOT TUB COUNCIL, LOCAL AUTHORITIES AND EQUIPMENT MANUFACTURERS. PLEASE REFER TO DIVING BOARD MANUFACTURERS FOR CORRECT POSITIONING AND INSTALLATION OF DIVING EQUIPMENT.

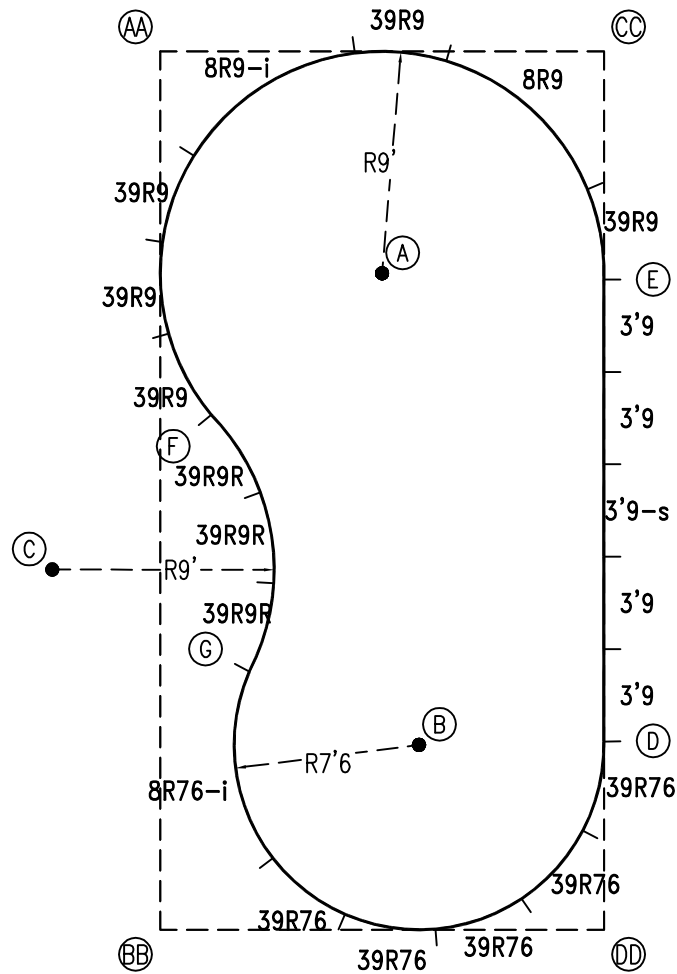

EXTERNAL INSTALLATION DATA

AA TO:	BB TO:	CC TO:	DD TO:
AA --	AA 35'-7 1/2"	AA 18'-0"	AA 39'-11"
BB --	BB --	BB 39'-11"	BB 18'-0"
CC --	CC --	CC --	CC 35'-7 1/2"
A 12'-8 3/4"	A 28'-1 1/4"	A 12'-8 3/4"	A 28'-1 1/4"
B 30'-0 1/4"	B 12'-10 3/4"	B 29'-1 1/4"	B 10'-7 1/4"
C 21'-5 1/2"	C 15'-3"	C 30'-8 1/4"	C 26'-8 3/4"
D 33'-3 1/2"	D 19'-6 1/2"	D 28'-0"	D 7'-7 1/2"
E 20'-2 3/4"	E 31'-11 1/4"	E 9'-3"	E 26'-4 1/2"
F 14'-10 1/2"	F 20'-11 3/4"	F 21'-8 1/2"	F 26'-3 1/4"
G 25'-4 3/4"	G 11'-0 3/4"	G 28'-11 3/4"	G 17'-9 1/2"

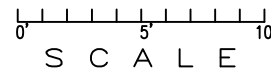

NOTICE

SWIMMING POOLS AND ACCESSORIES (INCLUDING DIVING BOARDS) ARE DANGEROUS WHEN IMPROPERLY USED OR INSTALLED. IT IS THE RESPONSIBILITY OF MUNICIPAL OFFICIALS, BUILDERS AND POOL OWNERS TO ADHERE TO ALL SAFETY RECOMMENDATIONS AND STANDARDS ISSUED BY THE POOL & HOT TUB COUNCIL, LOCAL AUTHORITIES AND EQUIPMENT MANUFACTURERS. PLEASE REFER TO DIVING BOARD MANUFACTURERS FOR CORRECT POSITIONING AND INSTALLATION OF DIVING EQUIPMENT.